

Hope's Old World Suite™ steel window profiles are specifically designed for projects requiring steel windows with historic arrow shaped profiles. With Hope's **Thermal Evolution™ Technology**, all the intrinsic strengths of solid hot-rolled steel are maintained along with enhanced thermal efficiency, exceeding the most stringent thermal codes.

Hope's Old World Suite thermal steel windows can be glazed with monolithic or insulated glass for energy efficiency. The unique window profiles and very narrow sightlines are ideal for new buildings as well as historic replacement projects.

### PRODUCT FEATURES

- Historically accurate sightlines
- Strength and life cycle of solid hot-rolled steel profiles
- Thermal break
- Thermal Evolution™ Technology - U-value tested to as low as **0.216**
- NFRC certified for thermal performance
- Fusion welded frame and muntin construction
- True divided lite or simulated divided lite arrow muntins
- Fixed windows accept up to 1-1/4" thick insulating glass
- Casement windows accept up to 7/8" thick insulating glass with snap-in glazing bead; 1" thick insulating glass with applied glazing bead
- ASTM tested for Air, Water and Structural
- Hope's Power of 5 Finishing System with hot-dip galvanizing pretreatment
- Hope's Signature Collection solid brass hardware

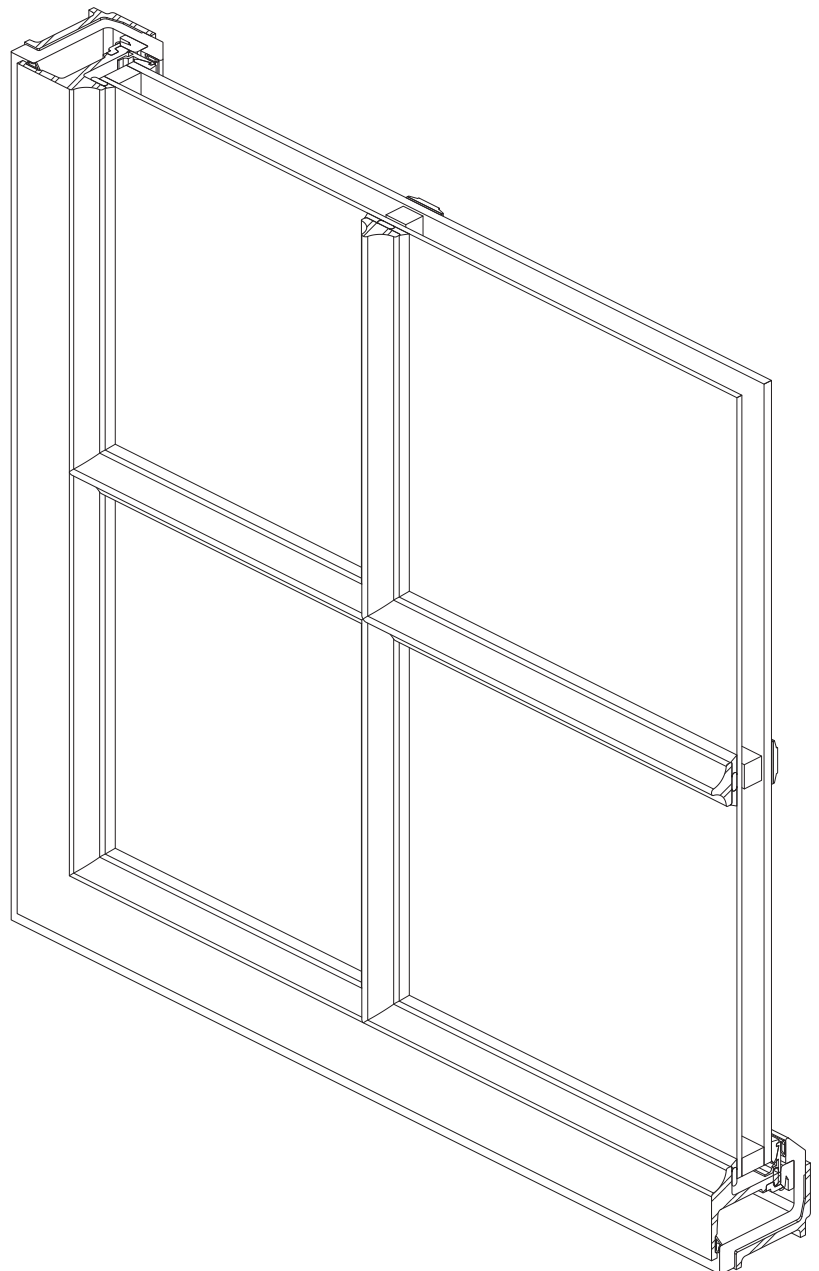

### FIXED

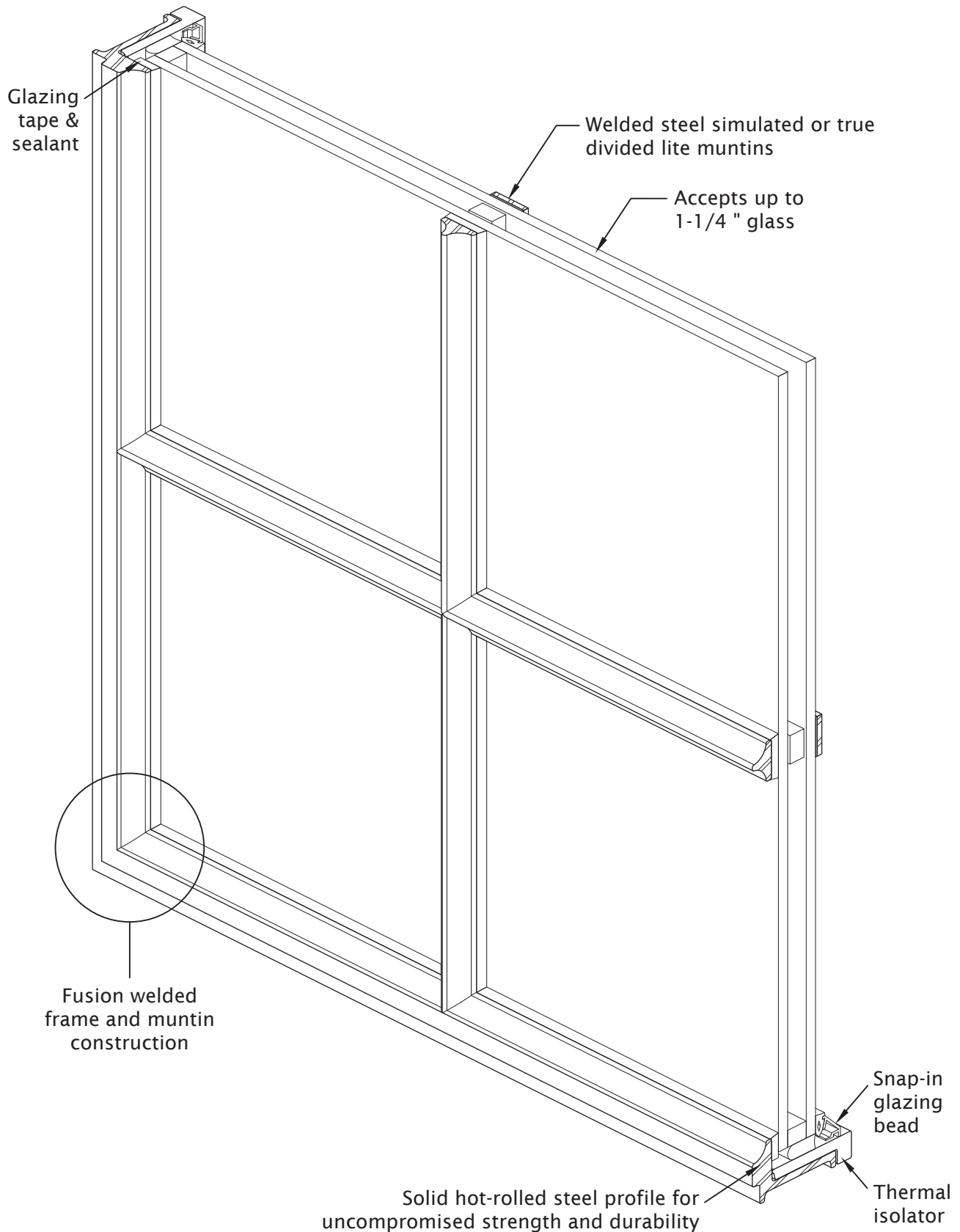

### OPERABLE

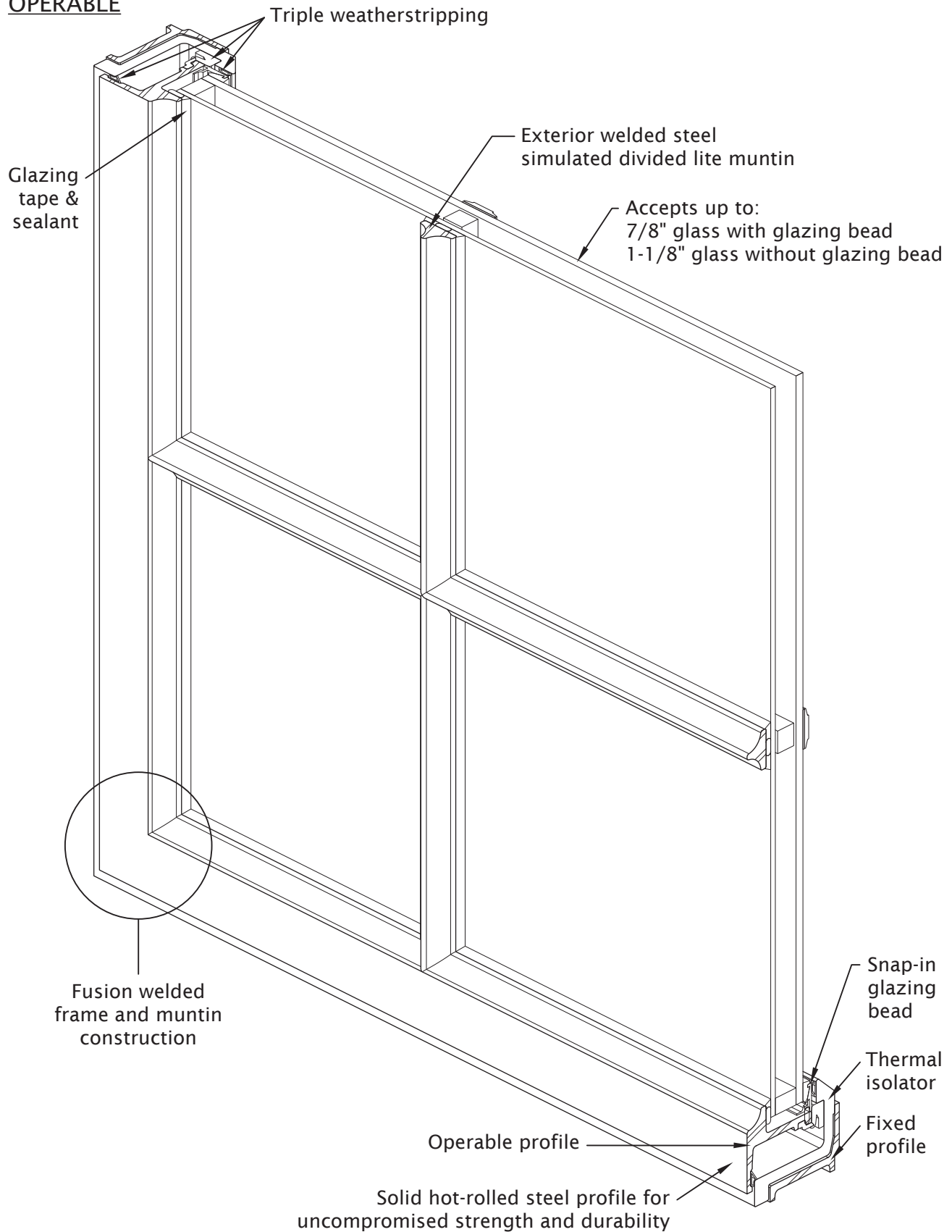

FIXED WINDOWS

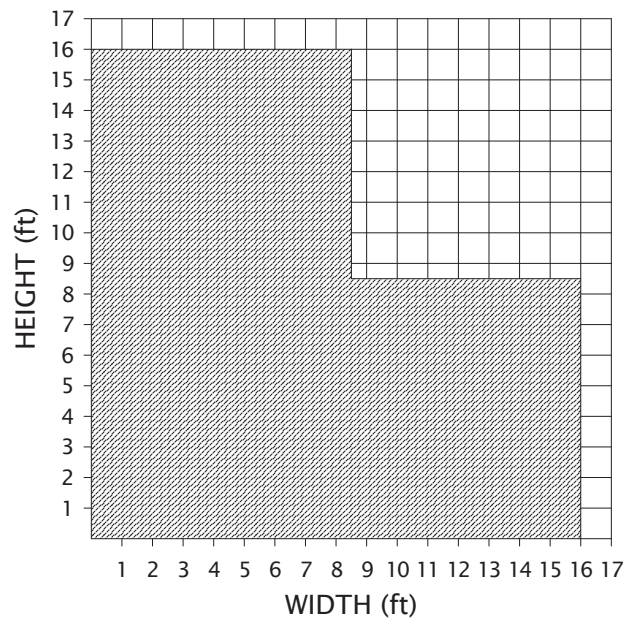

OPERABLE WINDOWS

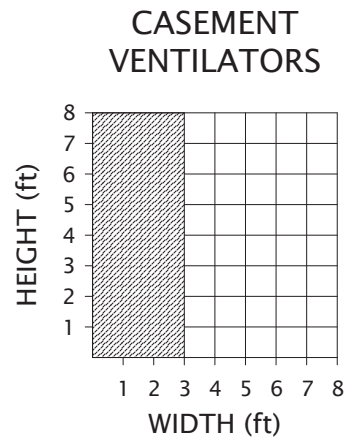
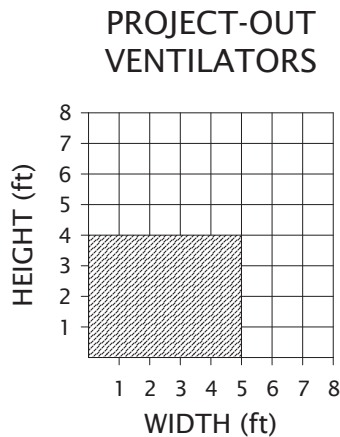
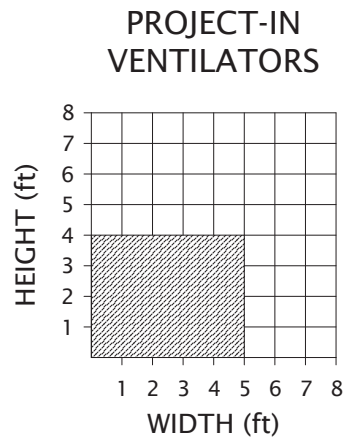

Sizes based on 7/8" insulating glass with 1/8" panes.  
For requirements exceeding the sizes shown, consult Hope's for design alternatives.

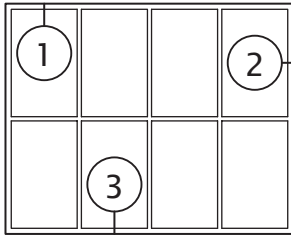

### 1 HEAD

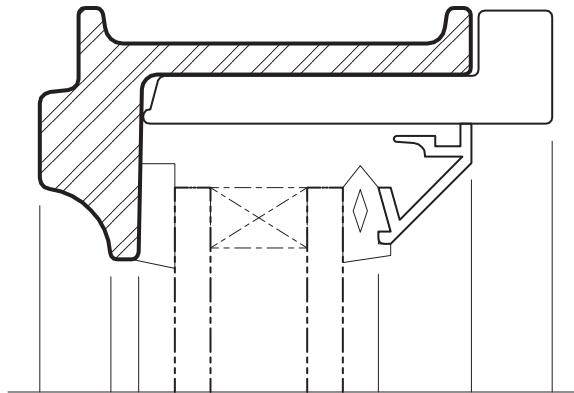

### 2 JAMB

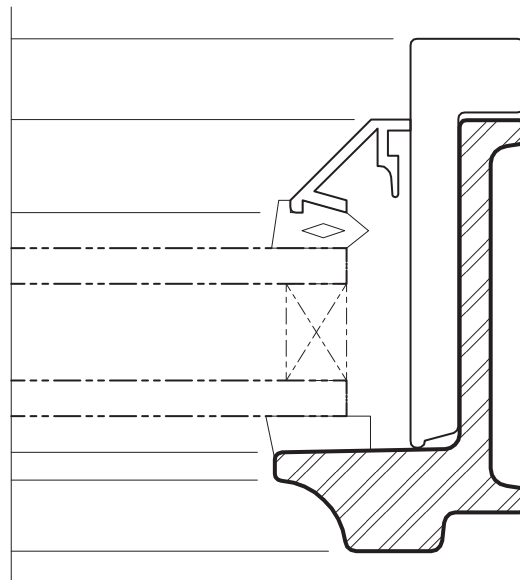

### 3 SILL

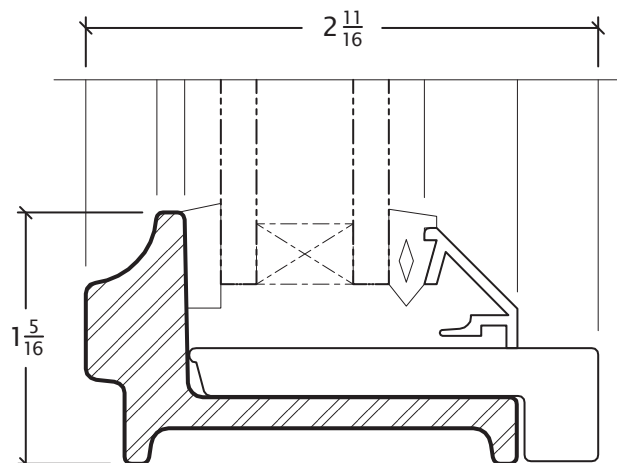

Details are full scale and shown with 7/8" thick glass. See page 28 for additional glass thickness and glazing bead options.  
All Hope's products are custom manufactured to your specific project requirements.

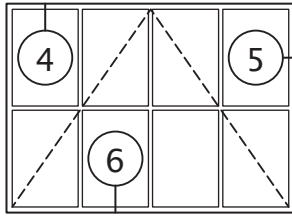

PROJECT-OUT  
(Awning)

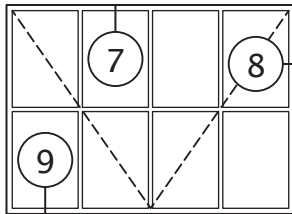

PROJECT-IN  
(Hopper)

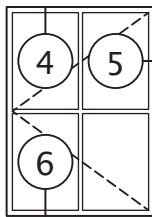

SINGLE SWING-OUT  
CASEMENT

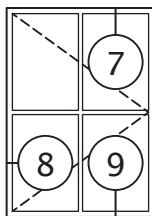

SINGLE SWING-IN  
CASEMENT

### ④ HEAD

OPERABLE

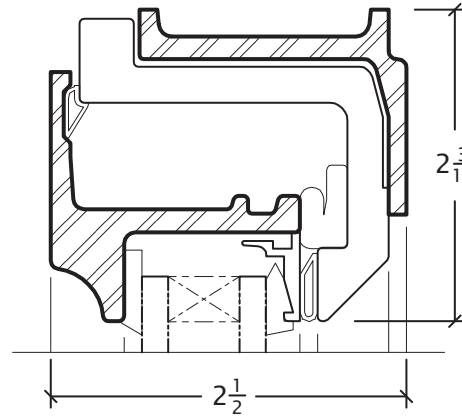

### ⑦ HEAD

OPERABLE

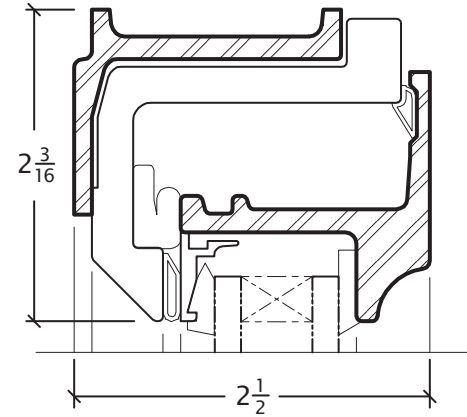

### ⑤ JAMB

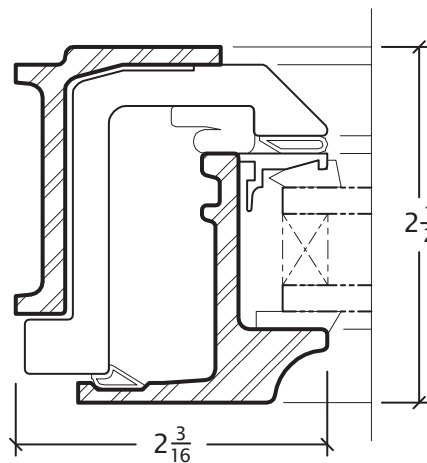

### ⑧ JAMB

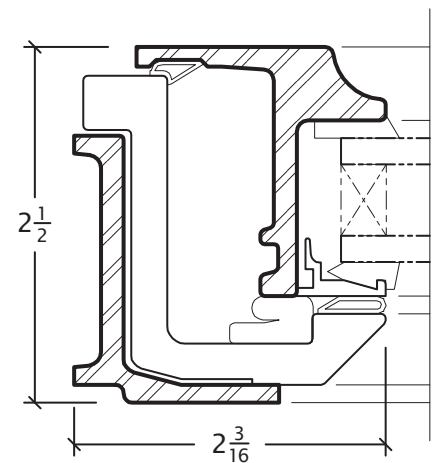

### ⑥ SILL

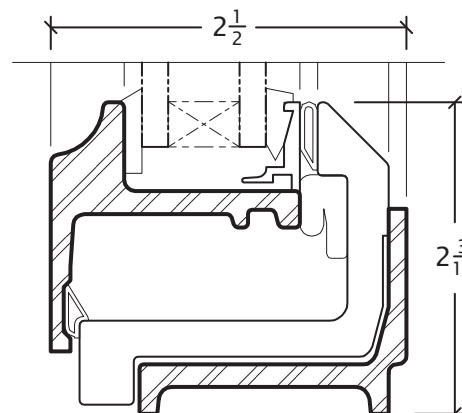

### ⑨ SILL

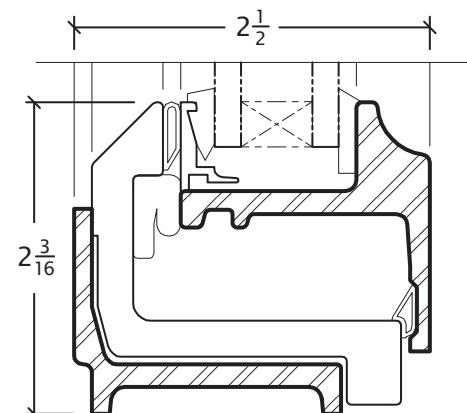

Details are 3/4 scale.

All Hope's products are custom manufactured to your specific project requirements.

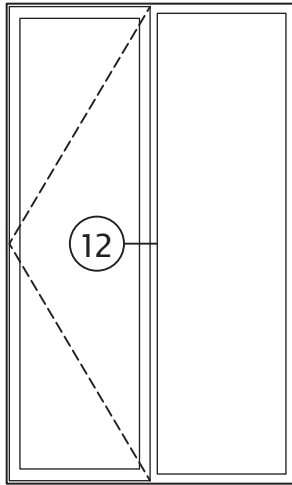

⑩ DOUBLE FOLDING VERTICAL MEETING RAIL

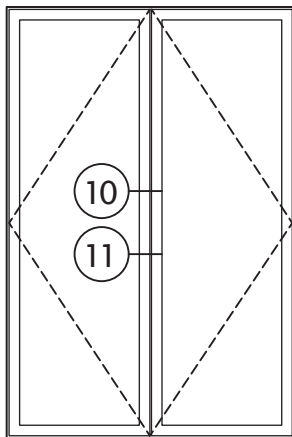
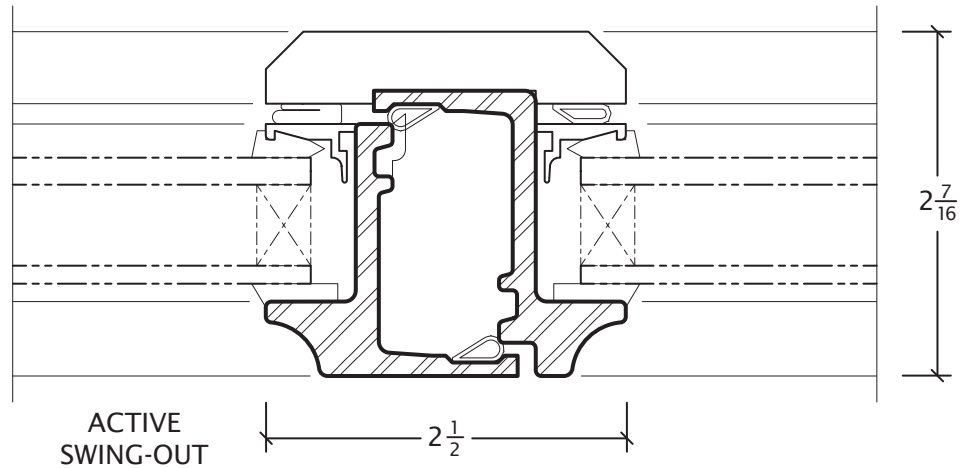

⑪ DOUBLE OPERABLE VERTICAL MEETING RAIL

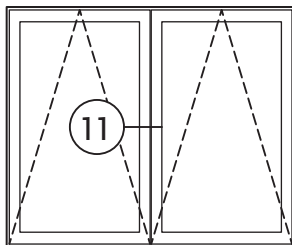
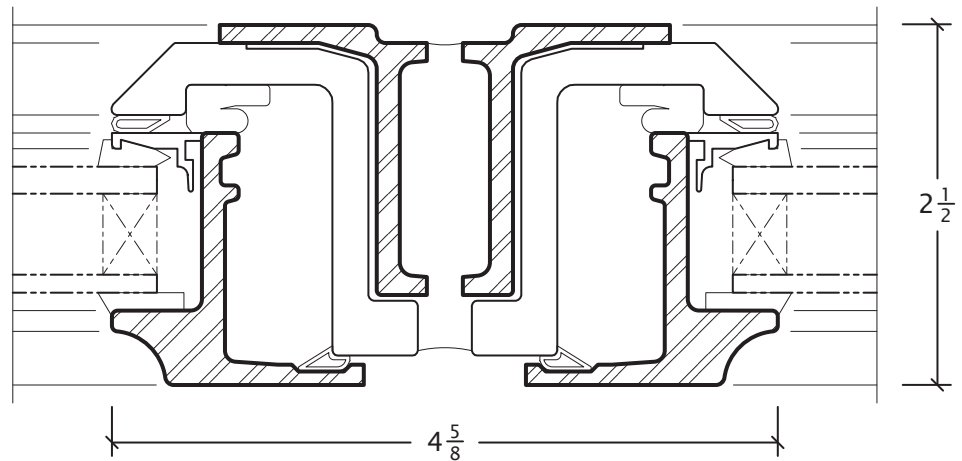

⑫ SINGLE OPERABLE VERTICAL MEETING RAIL

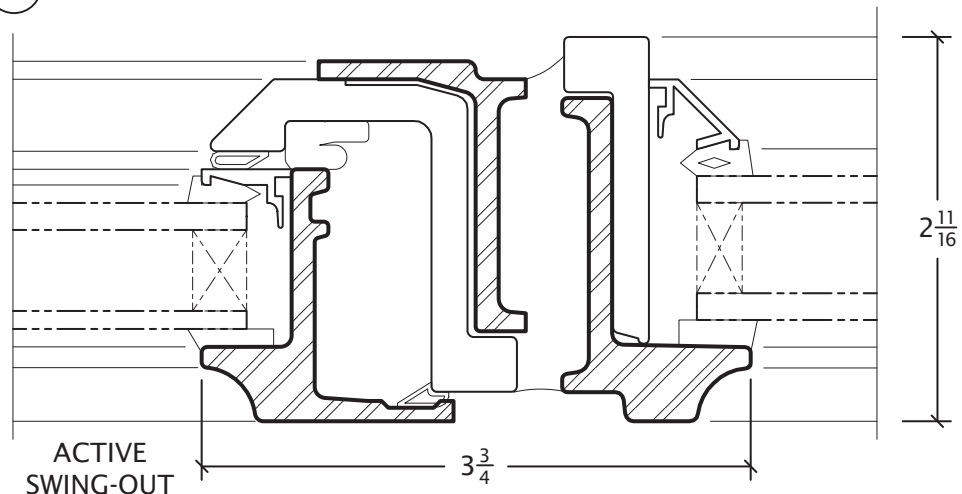

Details are 3/4 scale.

All Hope's products are custom manufactured to your specific project requirements.

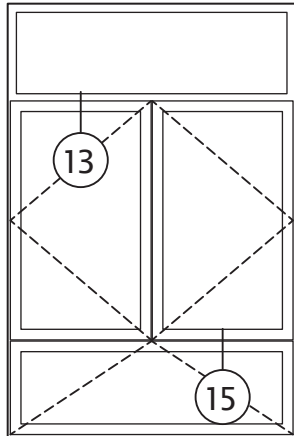

⑬ FIXED ABOVE OPERABLE  
HORIZONTAL RAIL

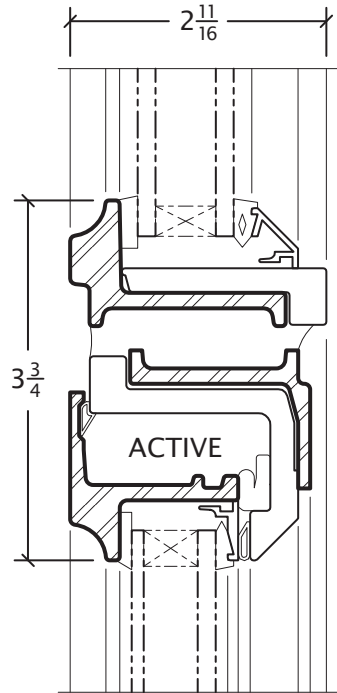

⑭ OPERABLE ABOVE FIXED  
HORIZONTAL RAIL

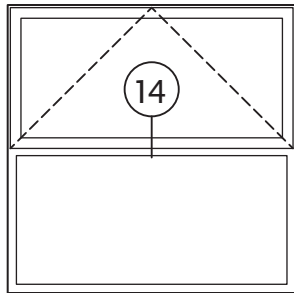
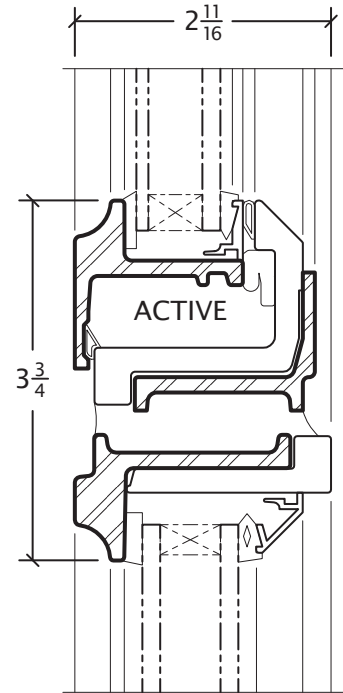

⑮ DOUBLE OPERABLE HORIZONTAL RAIL

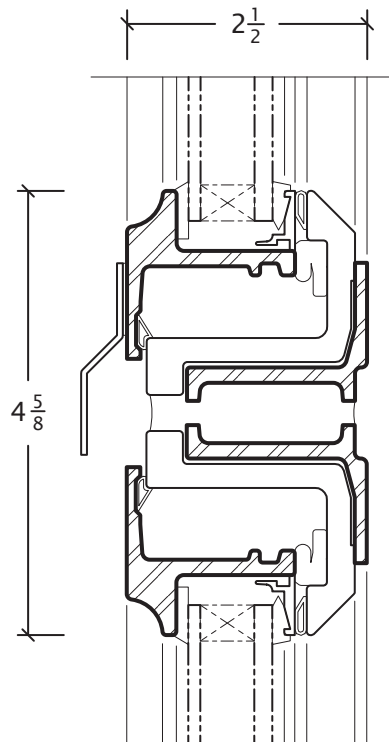

Details are half scale.

All Hope's products are custom manufactured to your specific project requirements.



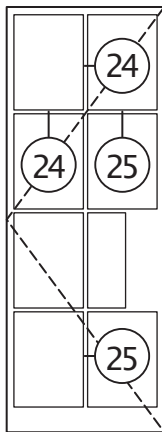
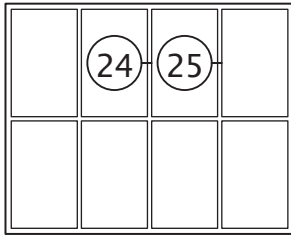

### 24 TRUE DIVIDED LITE MUNTIN PROFILES

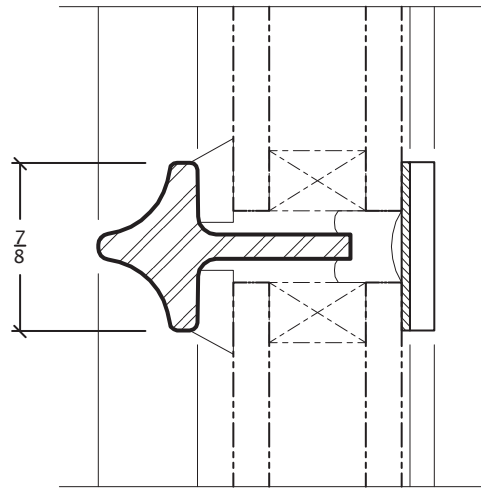

### 25 SIMULATED DIVIDED LITE MUNTIN PROFILES

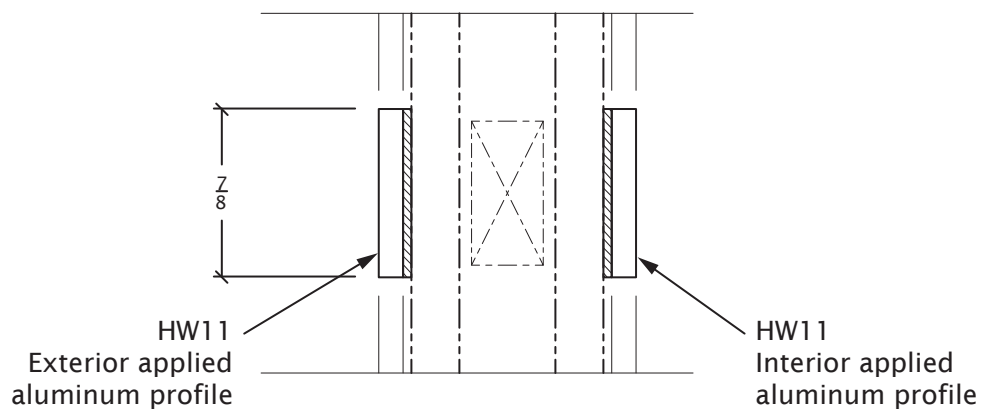
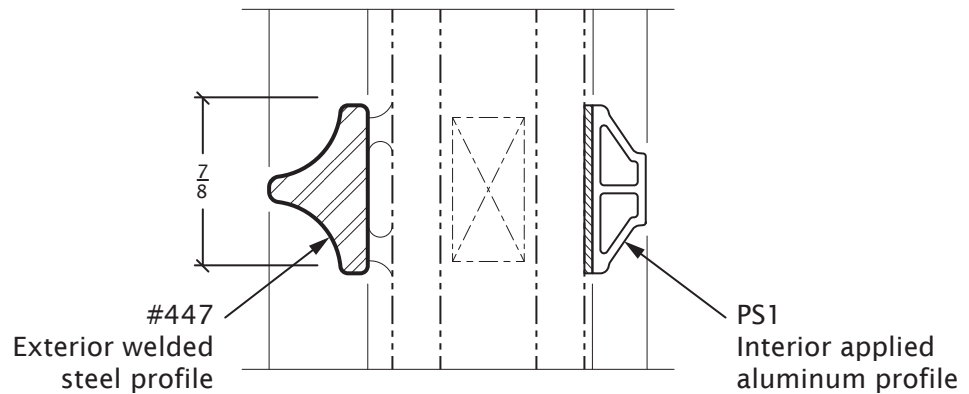

Details are full scale. Consult *Muntins, Mullions, Stacks & Deflection Channels* section of Hope's Architectural Binder for additional aluminum profile options. All Hope's products are custom manufactured to your specific project requirements.

### FIXED GLAZING BEAD OPTIONS

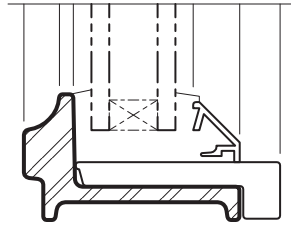

7/8" GLASS  
#340 SLOPED BEAD

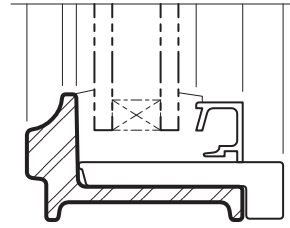

7/8" GLASS  
#339 SQUARE BEAD

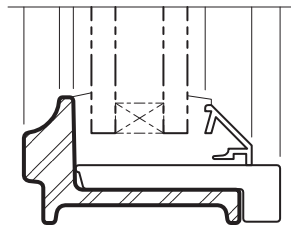

1" GLASS  
#340 SLOPED BEAD

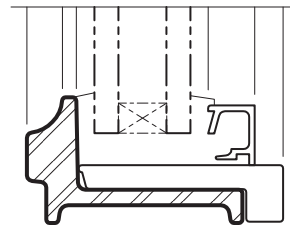

1" GLASS  
#339 SQUARE BEAD

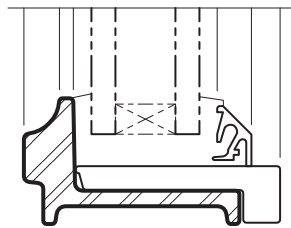

1-1/8" GLASS  
#241 SLOPED BEAD

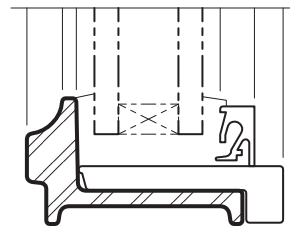

1-1/8" GLASS  
#41 SQUARE BEAD

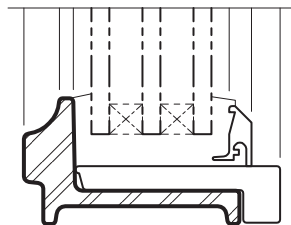

1-1/4" GLASS  
#242 SLOPED BEAD

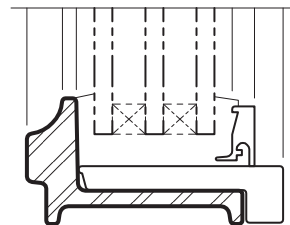

1-1/4" GLASS  
#42 SQUARE BEAD

### GLAZING BEAD NOTES

All true divided lite muntins have corresponding glazing beads to match the perimeter profiles.

Details are half scale and shown inside glazed.

### OPERABLE GLAZING BEAD OPTIONS

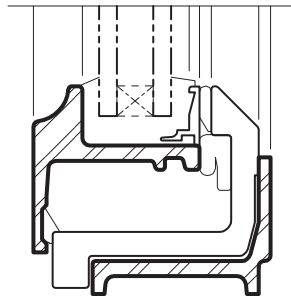

3/4" GLASS  
SLOPED PROFILE  
#24112-1 BEAD

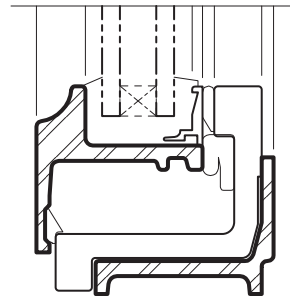

3/4" GLASS  
SQUARE PROFILE  
#24112-1 BEAD

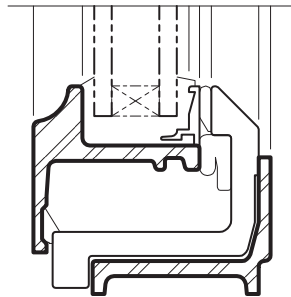

7/8" GLASS  
SLOPED PROFILE  
#24112-1 BEAD

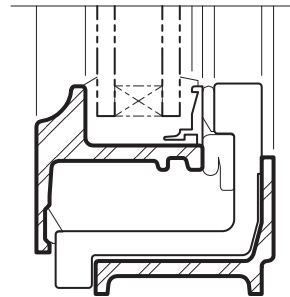

7/8" GLASS  
SQUARE PROFILE  
#24112-1 BEAD

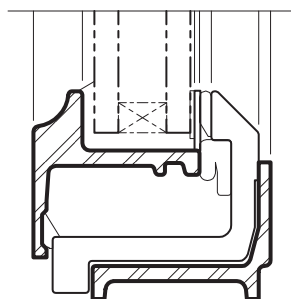

1" GLASS  
SLOPED PROFILE  
ALUMINUM FLAT

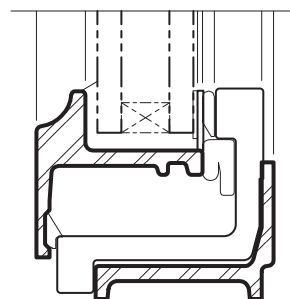

1" GLASS  
SQUARE PROFILE  
ALUMINUM FLAT

### GLAZING BEAD NOTES

1" thick glass is possible in operable units, however the glass cannot utilize a snap-in glazing bead.

Details are half scale and shown inside glazed.

INTENTIONALLY LEFT BLANK

Hope's Old World Suite™ steel door profiles are specifically designed for projects requiring steel doors with historic arrow shaped profiles. With Hope's **Thermal Evolution™ Technology**, all the intrinsic strengths of solid hot-rolled steel are maintained along with enhanced thermal efficiency, exceeding the most stringent thermal codes.

Hope's Old World Suite thermal steel doors can be glazed with monolithic or insulated glass for energy efficiency. The unique steel profiles and very narrow sightlines are ideal for new buildings as well as historic replacement projects.

### PRODUCT FEATURES

- Historically accurate sightlines
- Strength and life cycle of solid hot-rolled steel profiles
- Thermal break
- Thermal Evolution™ Technology
- Fusion welded frame and muntin construction
- True divided lite or simulated divided lite arrow muntins
- Accepts up to 7/8" thick insulating glass with snap-in glazing bead; 1" thick insulating glass with applied glazing bead
- ASTM tested for Air, Water and Structural
- Hope's Power of 5 Finishing System with hot-dip galvanizing pretreatment
- Hope's Signature Collection solid brass door hardware
- Available with mortise, multipoint, and cremone lock options

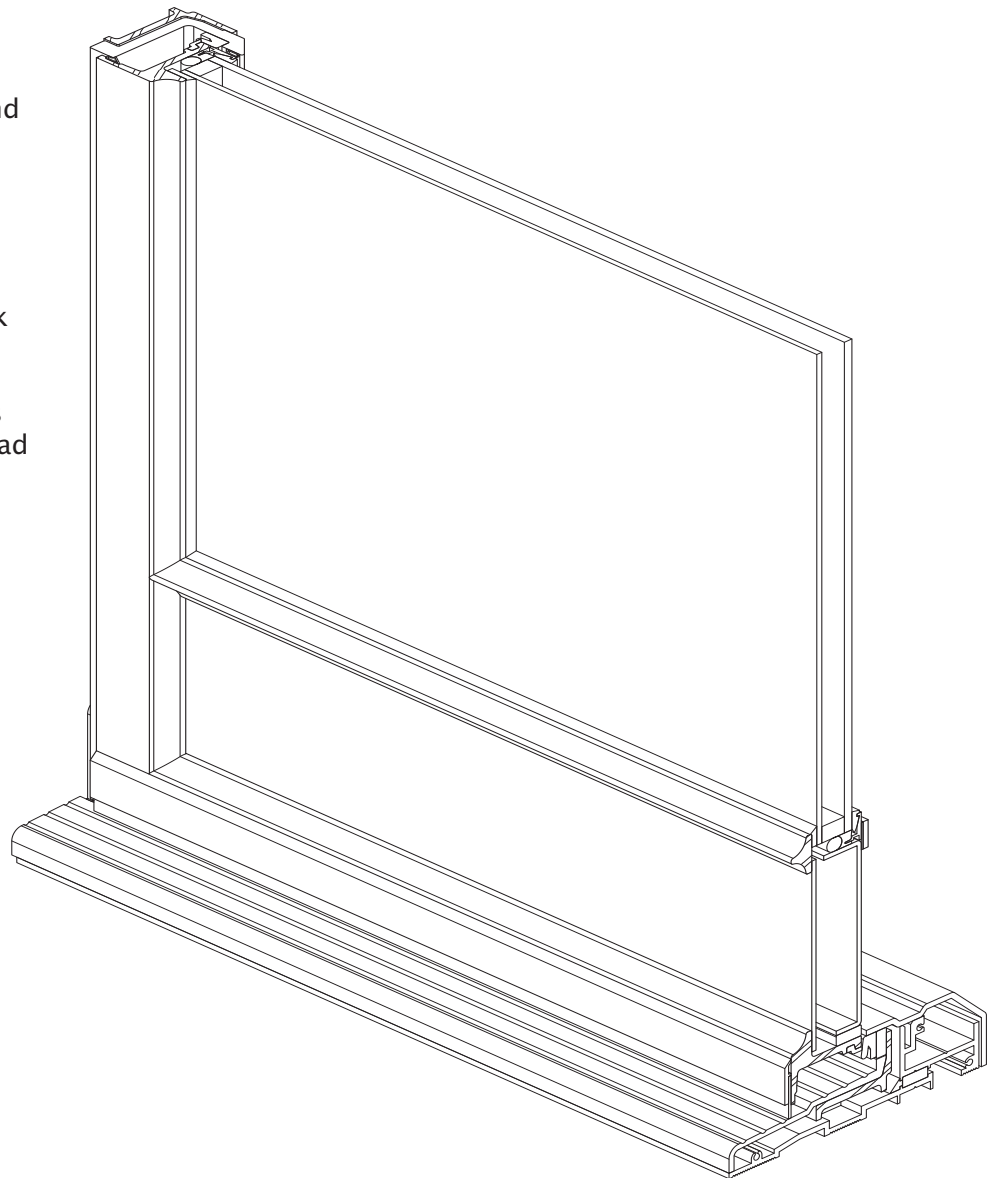

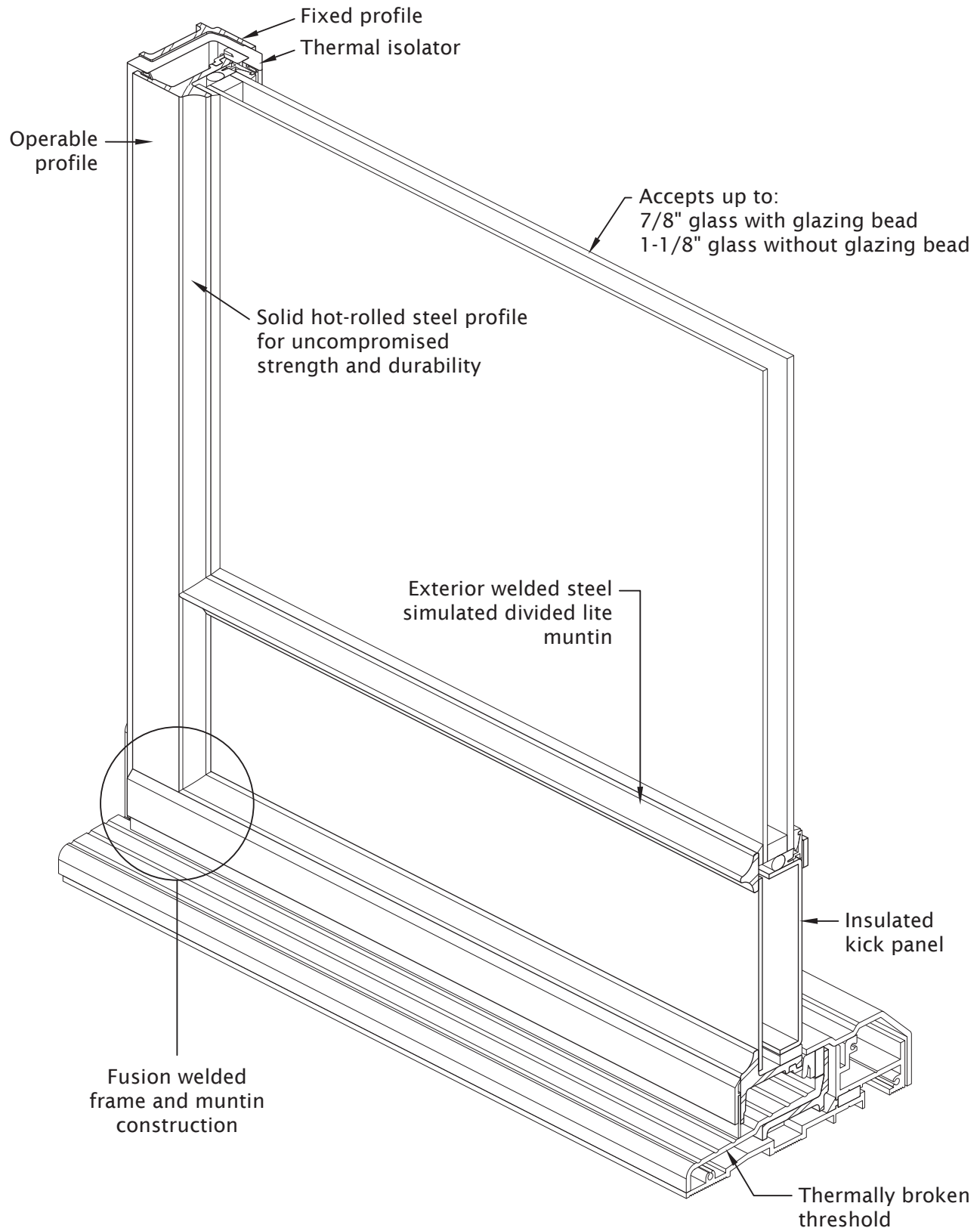

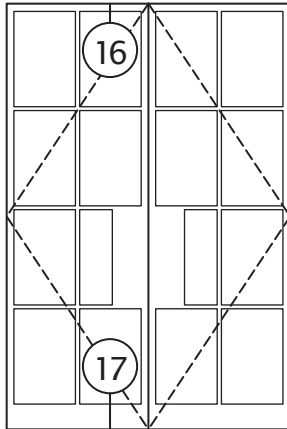

①6 HEAD

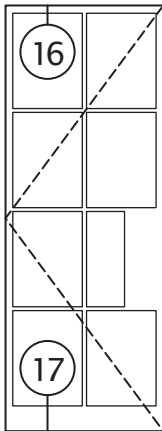
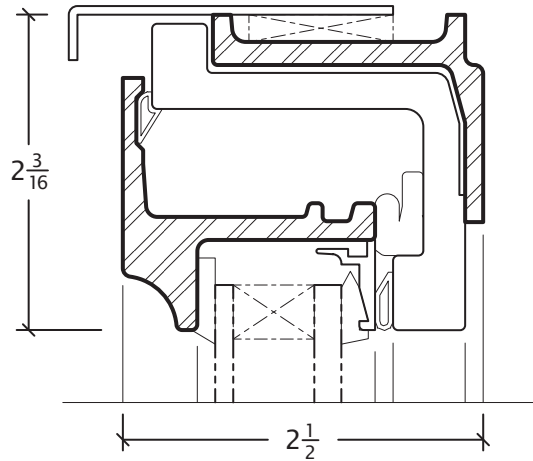

①7 THRESHOLD

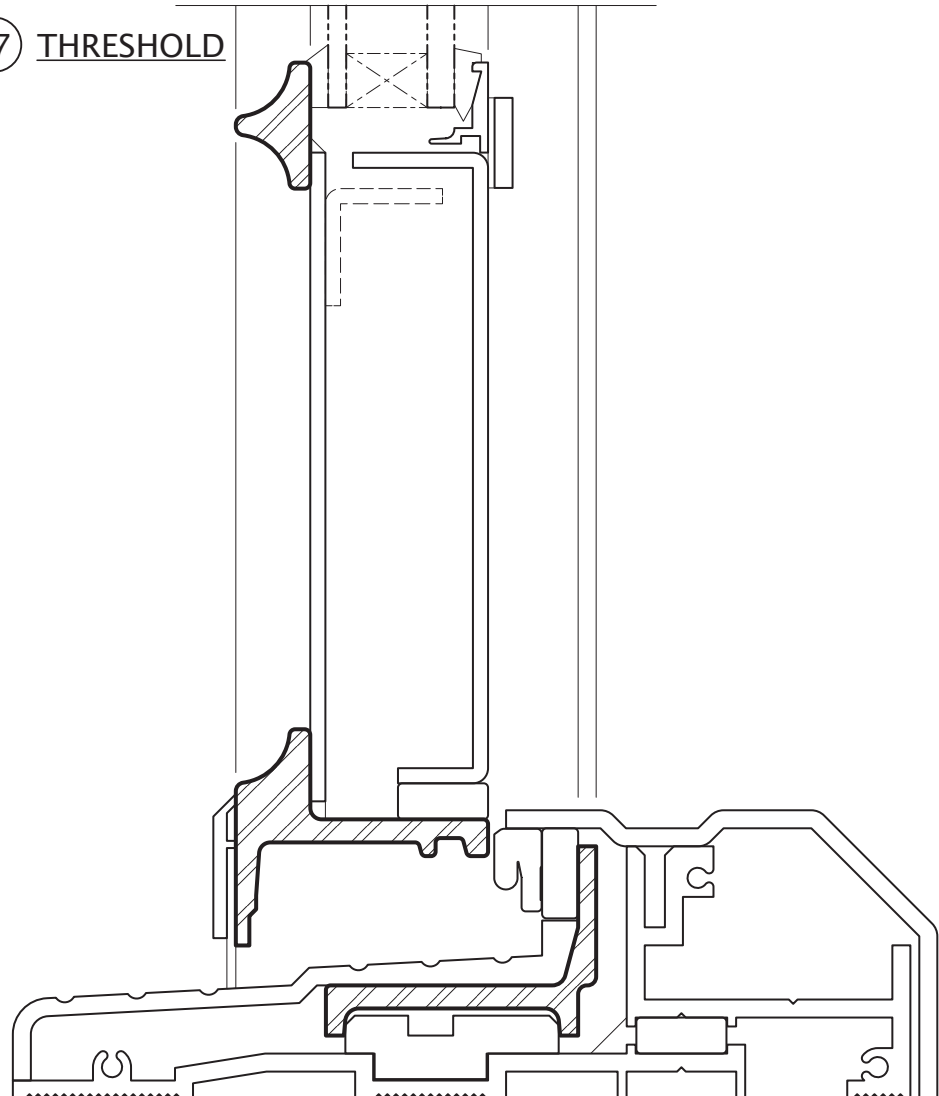

Details are 3/4 scale.

All Hope's products are custom manufactured to your specific project requirements.

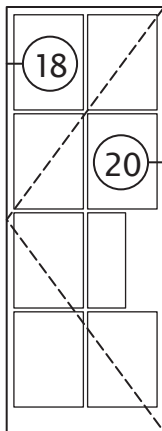
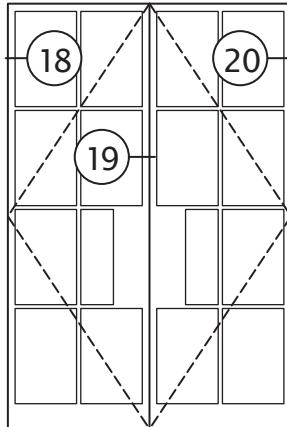

18 JAMB

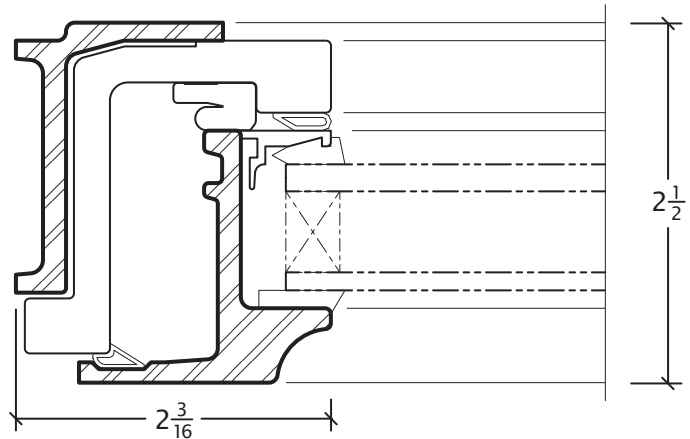

19 DOUBLE FOLDING MEETING RAIL

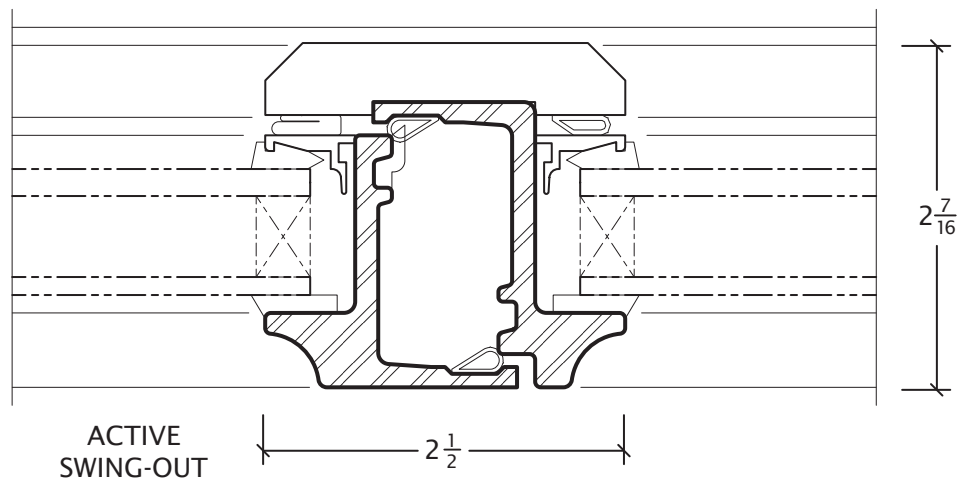

20 JAMB

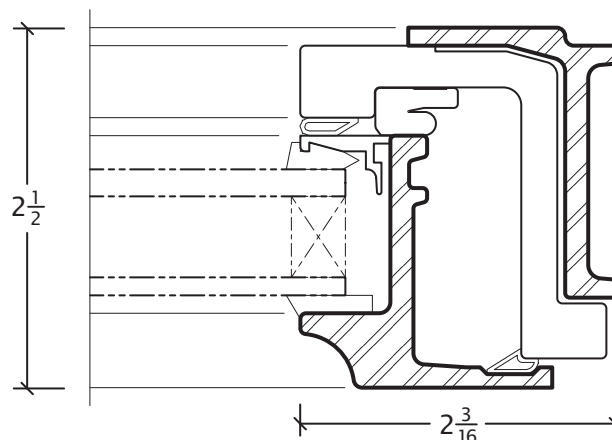

Details are 3/4 scale.

All Hope's products are custom manufactured to your specific project requirements.



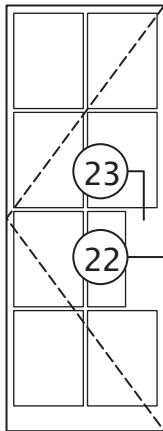
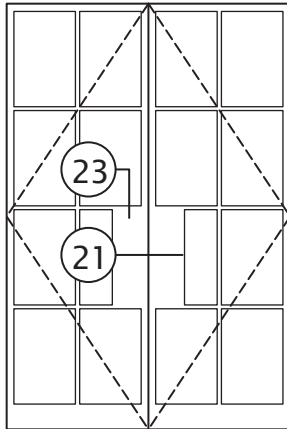

### (21) LOCKBOX AT DOUBLE FOLDING MEETING RAIL

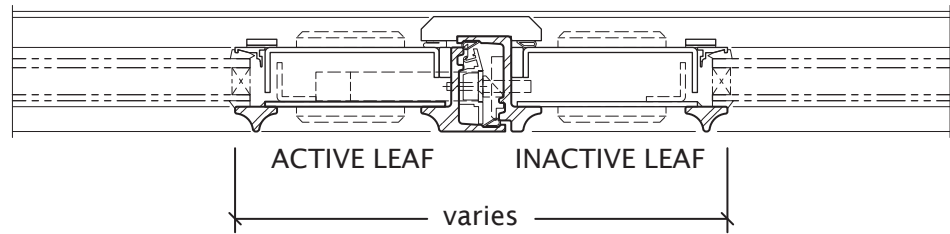

### (22) LOCKBOX AT JAMB

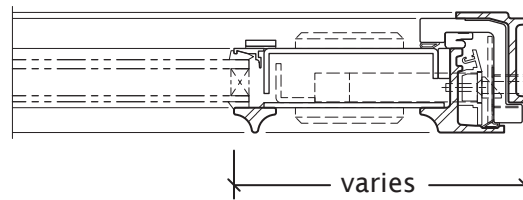

### (23) LOCKBOX

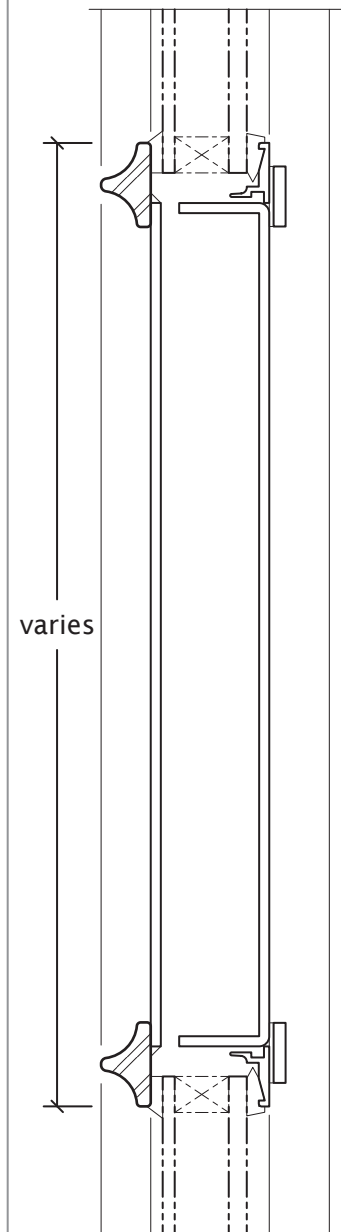

Details #21 and #22 are 1/4 scale. Detail #23 is 1/2 scale.  
All Hope's products are custom manufactured to your specific project requirements.

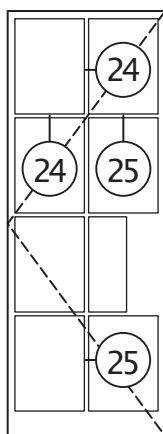
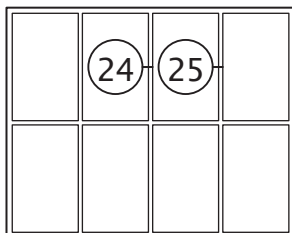

### 24 TRUE DIVIDED LITE MUNTIN PROFILES

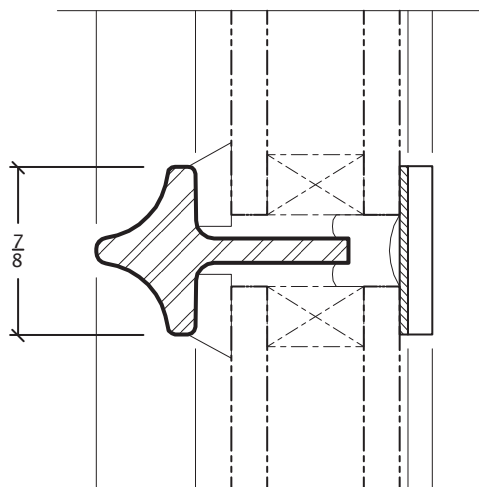

### 25 SIMULATED DIVIDED LITE MUNTIN PROFILES

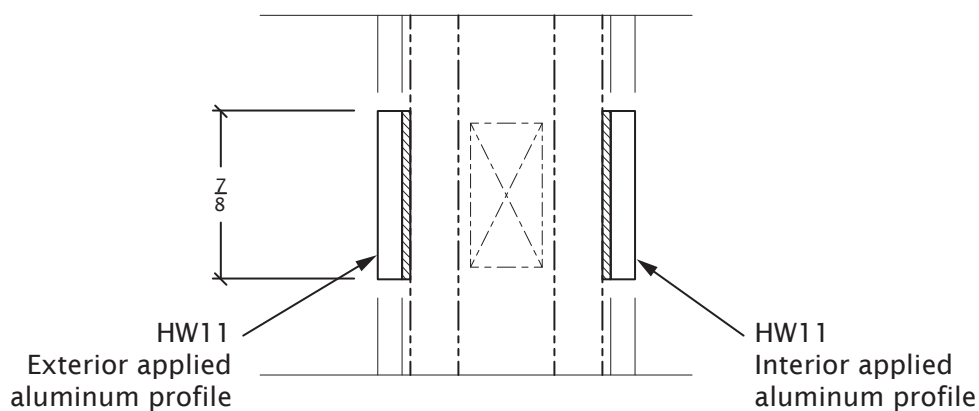
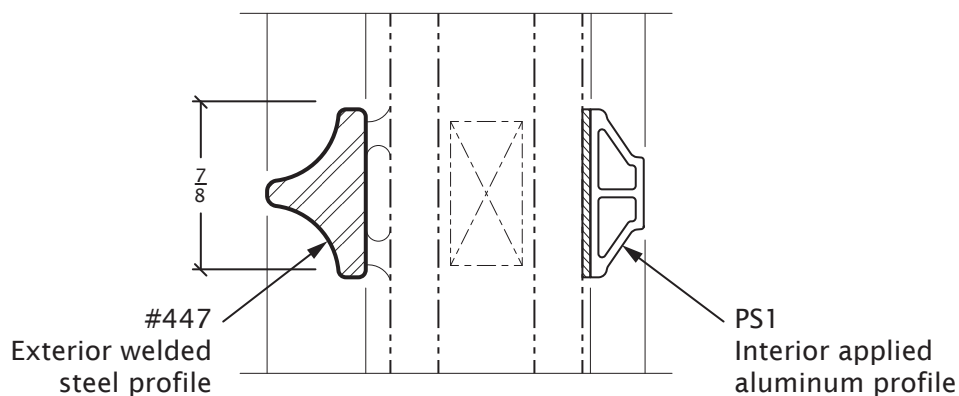

Details are full scale. Consult *Muntins, Mullions, Stacks & Deflection Channels* section of Hope's Architectural Binder for additional aluminum profile options. All Hope's products are custom manufactured to your specific project requirements.

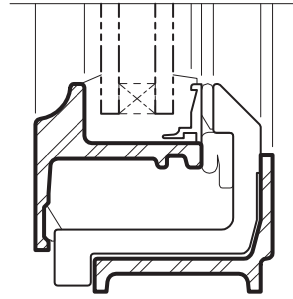

3/4" GLASS  
SLOPED PROFILE  
#24112-1 BEAD

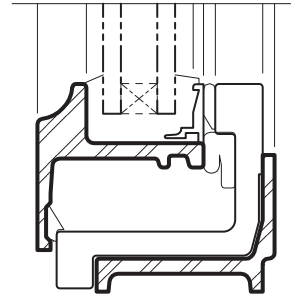

3/4" GLASS  
SQUARE PROFILE  
#24112-1 BEAD

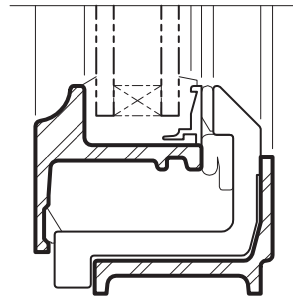

7/8" GLASS  
SLOPED PROFILE  
#24112-1 BEAD

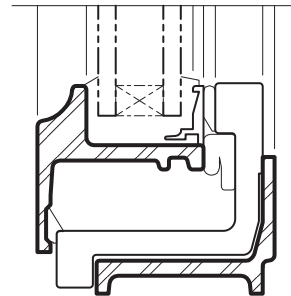

7/8" GLASS  
SQUARE PROFILE  
#24112-1 BEAD

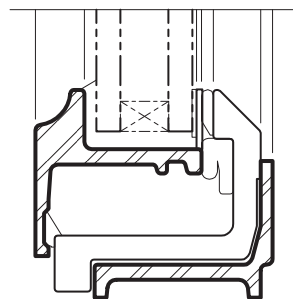

1" GLASS  
SLOPED PROFILE  
ALUMINUM FLAT

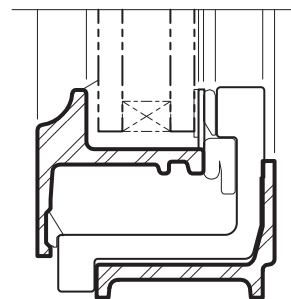

1" GLASS  
SQUARE PROFILE  
ALUMINUM FLAT

### **GLAZING BEAD NOTES**

1" thick glass is possible in door units, however the glass cannot utilize a snap-in glazing bead.

Details are half scale and shown inside glazed.

INTENTIONALLY LEFT BLANK